

4-Part Timber Doorframe

DFT1044P

FD90 (FCH)

Isometric

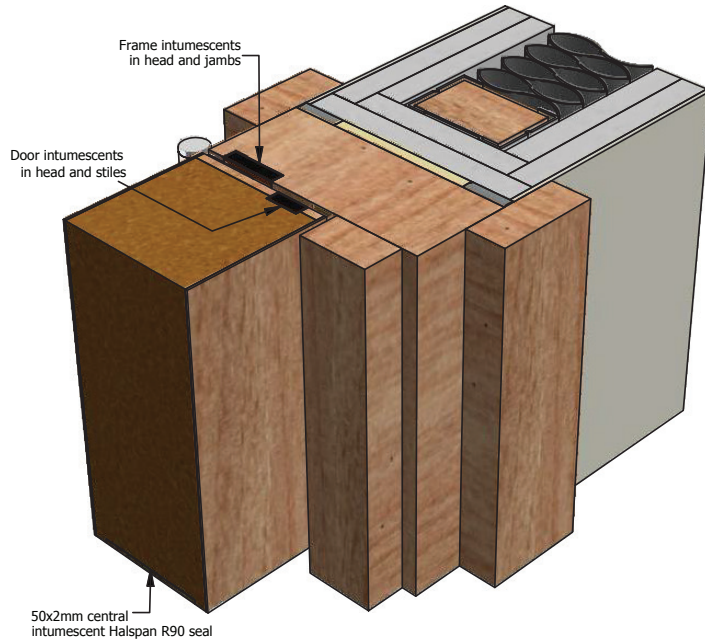

Head / Jamb Joint

- Mortice & Tenon Open Joint

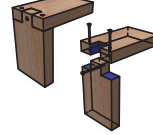

- Flat Half-Lap Joint



- Mitred Joint



- Butt Joint



Double Leaf

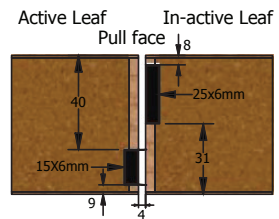

Dimensions (Jambs and Head)

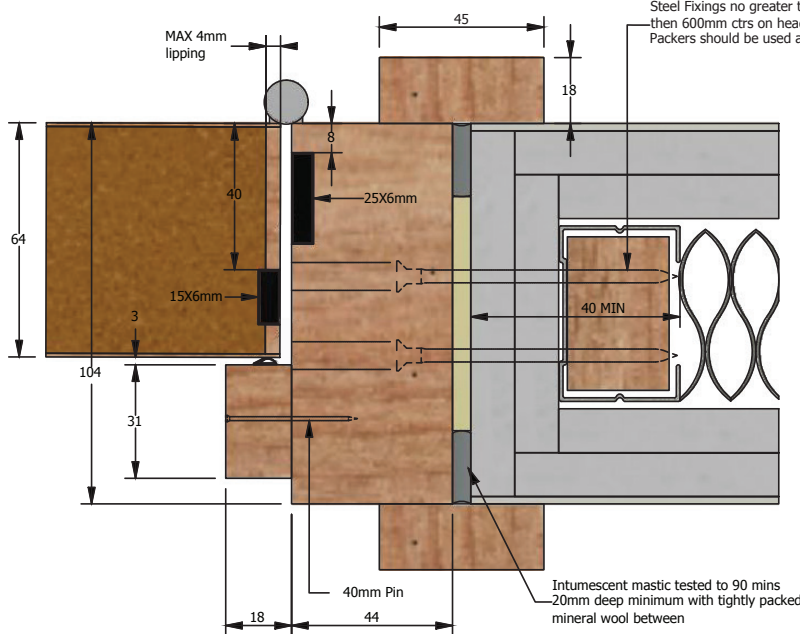

Over-Panel Transom

Maximum 1000mm height

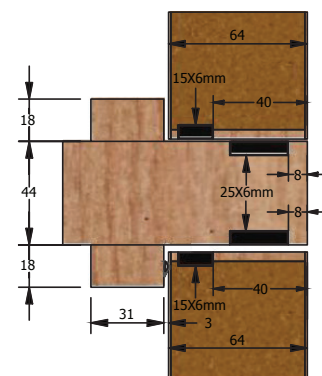

Transom to be side fixed through Stiles



forza-doors.com
01403 711 126
info@forza-doors.com

TITLE	4-Part Timber Doorframe
CODE	DFT1044P FD90 (FCH)
SHEET	1 of 1
DATE	15/02/2024
ISSUE	6
DWG No.	FZD0478

DOOR	FCH90
LINER	Solid Timber minimum density 640kg/m ³
STOP/ARCHITRAVE	Solid Timber
FINISH	Precatalyst Lacquer
LIPPING	Solid Timber - Finish max. 4mm edge lippings
SEALS	25x4mm, 20x4mm, 50x2mm, ST1009