

# PAXTON PRO EURO EN179 Kit

## FD30/FD30s

Isometric

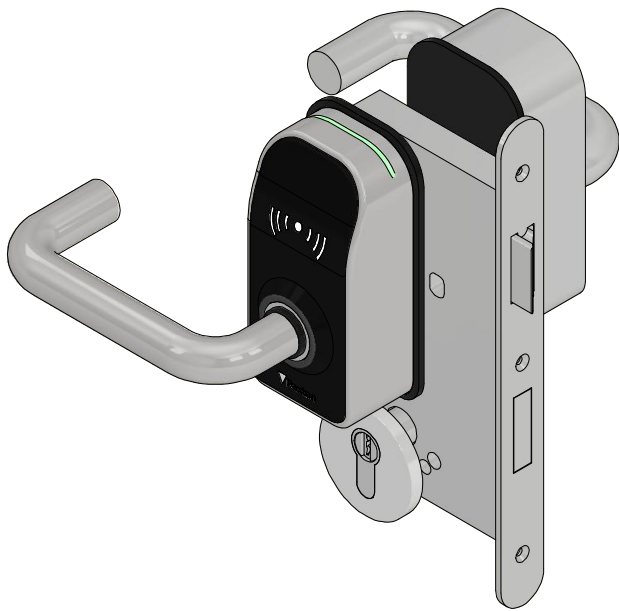

Perspective



Plan

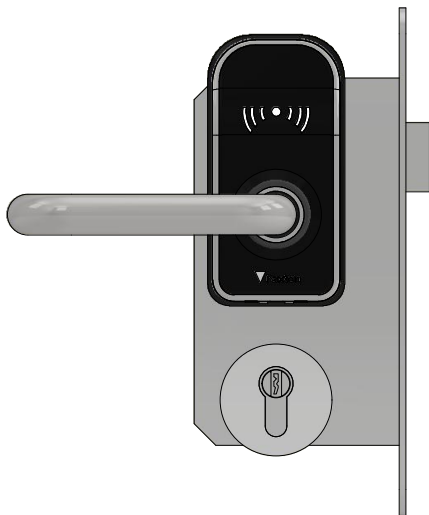

Front

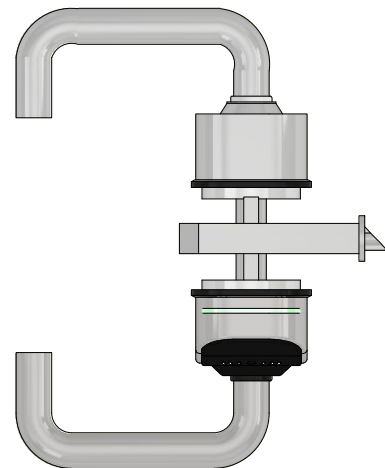

\*Lock Details For Illustrative Purpose Only.



forza-doors.com

01403 711 126

info@forza-doors.com

### Specification

Door: Min. 44mm Timber Particle Board  
FCH30, FCS30 & FCE30

1mm MAP/Intumescent Protection Encasing  
latch body & fitted beneath strike & forend

**Title** PAXTON PRO EURO EN179 Kit

**Code** Lock Body\_901-015-EX &  
Latch\_PRO 900-600 INTERIOR

**Issue** 1 **Sheet** 1of2

**Date** 06/01/2026

**Dwg Nr.** FZD5637

# PAXTON PRO EURO EN179 Kit

## FD30/FD30s

### Exploded View

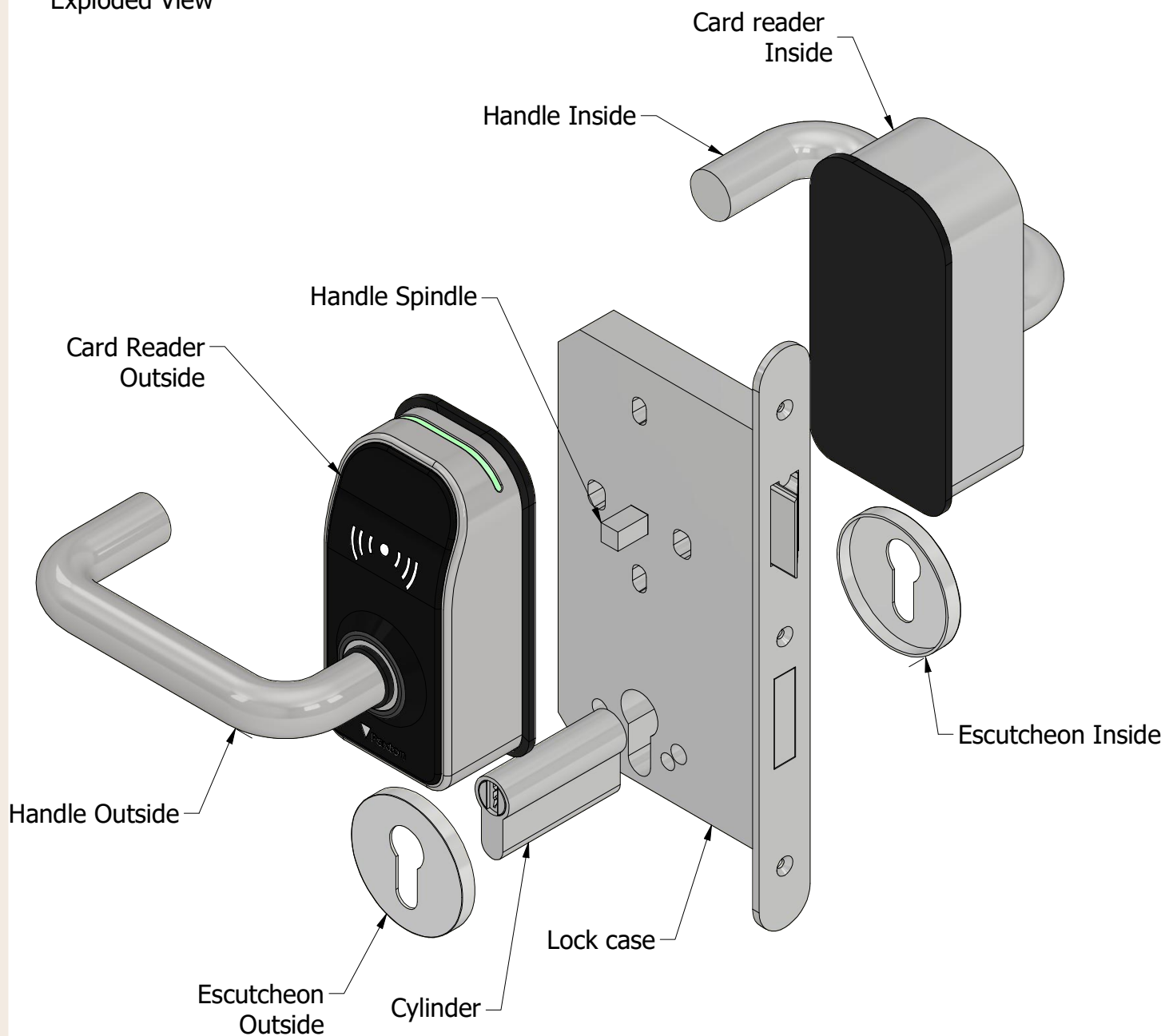

\*Lock Details For Illustrative Purpose Only.



forza-doors.com

01403 711 126

info@forza-doors.com

### Specification

Door: Min. 44mm Timber Particle Board  
FCH30, FCS30 & FCE30

1mm MAP/Intumescent Protection Encasing  
latch body & fitted beneath strike & forend

**Title** PAXTON PRO EURO EN179 Kit

**Code** Lock Body\_901-015-EX &  
Latch\_PRO 900-600 INTERIOR

**Issue** 1 **Sheet** 2of2

**Date** 06/01/2026

**Dwg Nr.** FZD5637