

Timber Laminated Sections

FD30/30s & FD60/60s

Isometric

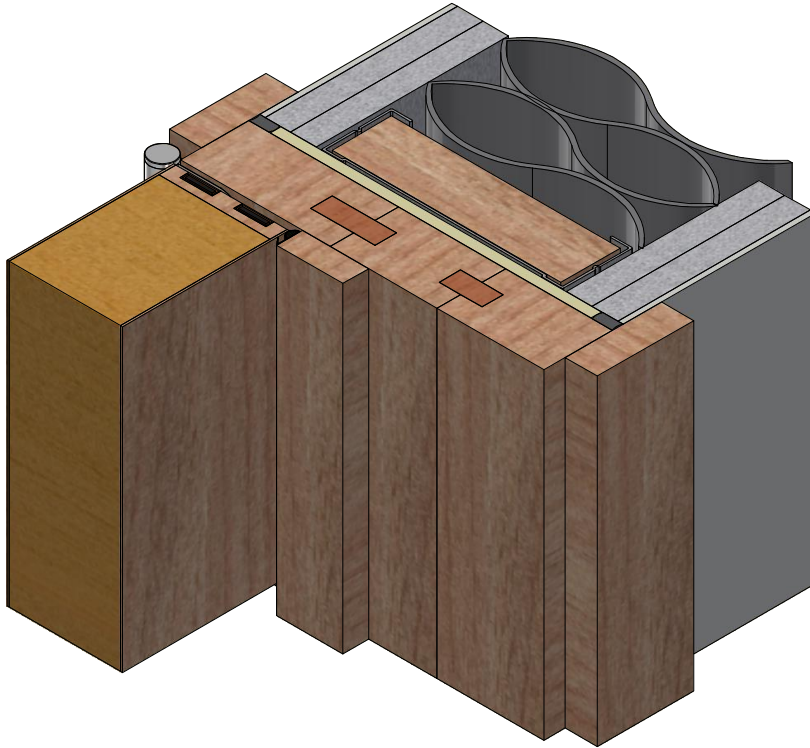

Dimensions

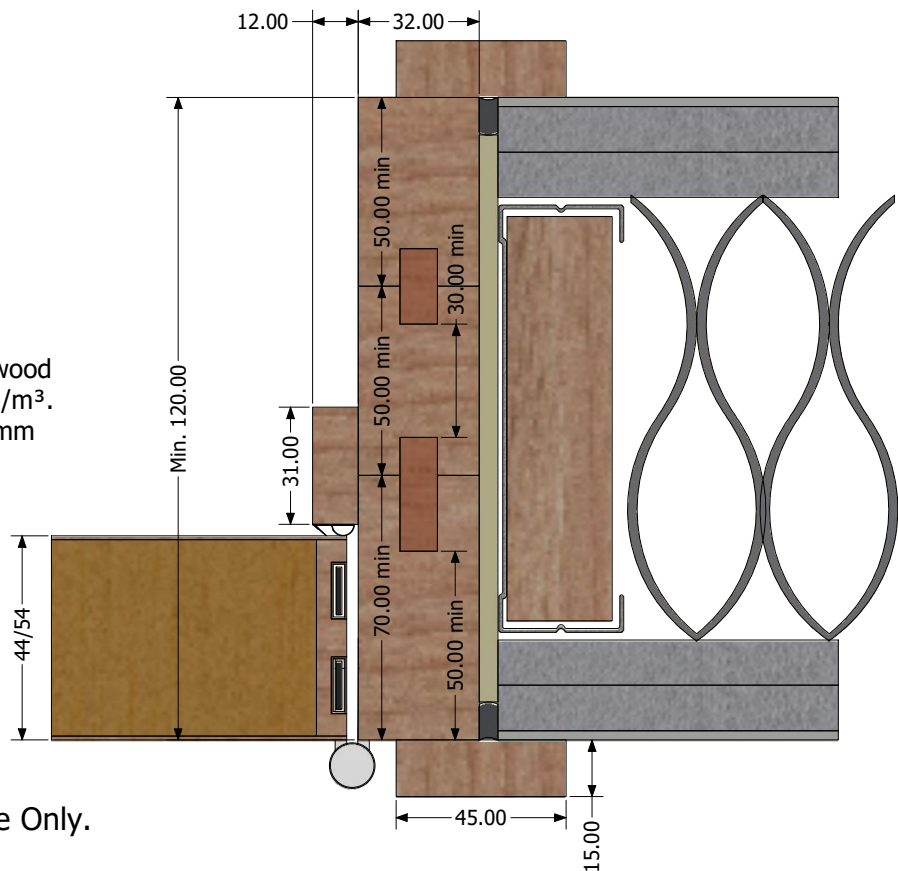

* Liner must be adhered using hardwood splines and PU adhesive - min. 640kg/m³.
Splines min. 20x12mm - max. 40x12mm
* Drawing show indicative FD60 seals arrangement.

*Details For Illustrative Purpose Only.



forza-doors.com
01403 711 126
info@forza-doors.com

Specification

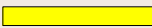
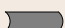
Door:	Timber Particle Board 44/54mm
Liner:	Hardwood with min. of 640kg/m ³
Stop/Architrave:	Solid Timber
	STD seals arrangements FD30 or FD60
	Mineral Wool
	Intumescent mastic

Title	Timber Laminated Sections		
Code			
Issue	1	Sheet	1of1
Date	05/01/2026		
Dwg Nr.	FZD5636		