

DFT1042PT FD60

2-PART SHADOW-GAP TIMBER DOORFRAME

Isometric

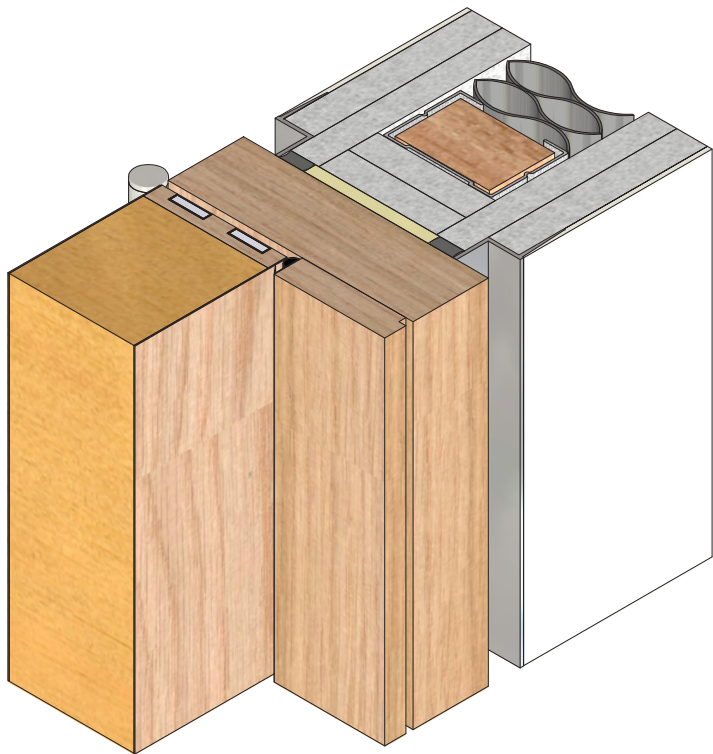

Suggested Build Method

- Walls double plaster-boarded up to structure opening.
- Frame installed with approximately 5mm packing zones all round.
- Packing zone to include Mineral wool and Intumescent sealant
- Site to router outer plasterboard for Edge trim 12.5mm deep and 12.5mm wide from back of door frame.
- Aluminium trims** are indicative, the use is **optional** in this structure opening detail. (Max 12.5mm deep reveal)

Dimensions

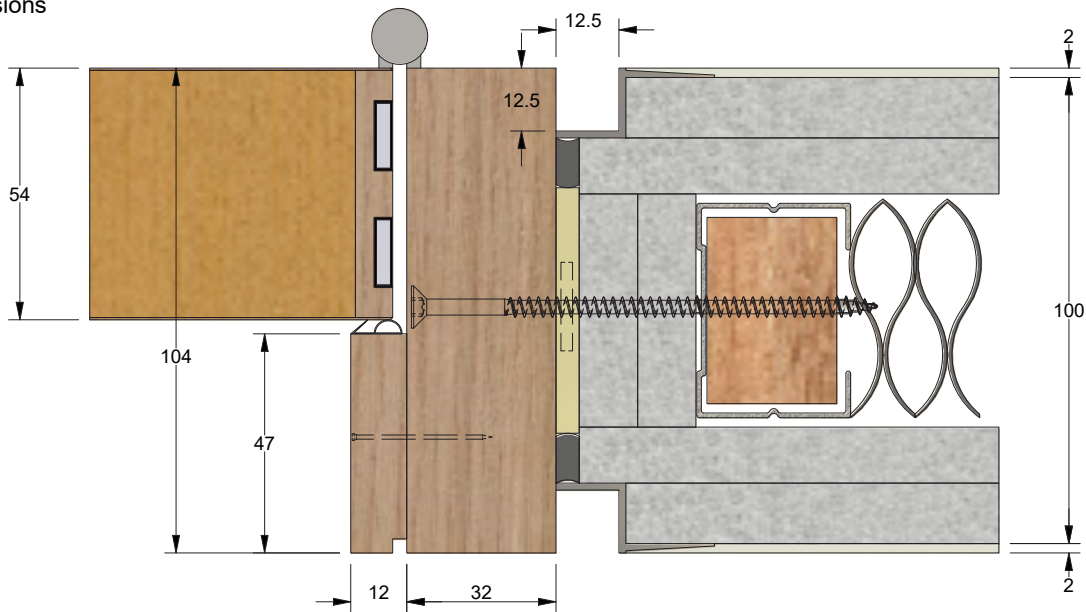

Specification

Door:	Timber Particle Board
Liner:	Hardwood / MDF
Stop:	Hardwood
	Mineral wool
	Intumescent mastic

	Fixing Packer
	15x4mm Intumescent

Title	2-Part Shadow-gap Timber Doorframe		
Code	DFT1042PT FD60		
Sheet	1	Date	24/04/2024
Issue	4	Dwg No	FZD0902



forza-doors.com
01403 711 126
info@forza-doors.com