

Please, Provide doors & Structural Opening detail below:		
Reference	----	Site Dim (mm)
DIM A	Door size (Height x Width x Thickness)	
DIM B	Inside frame Size	
DIM C	Structure Opening Size	

Intumescent Colour Key <input checked="" type="checkbox"/>	
BL = Black <input type="checkbox"/>	BR = Brown <input type="checkbox"/>
W = White <input type="checkbox"/>	G = Grey <input type="checkbox"/>

Door Handing (DIN) <input checked="" type="checkbox"/>	
Left Hand Open <input type="checkbox"/>	Right Hand Open <input type="checkbox"/>

Please, Provide Frame detail below:	
Reference	Site Dim (mm)
Wall thickness	
Frame Liner	
Frame Architrave	
Frame Stop	

ALL HEIGHT DIMS TAKEN FROM FINISHED FLOOR LEVEL
SO DOORS SUPPLIED TO EXACT HEIGHT
FRAMES SUPPLIED OVER HEIGHT

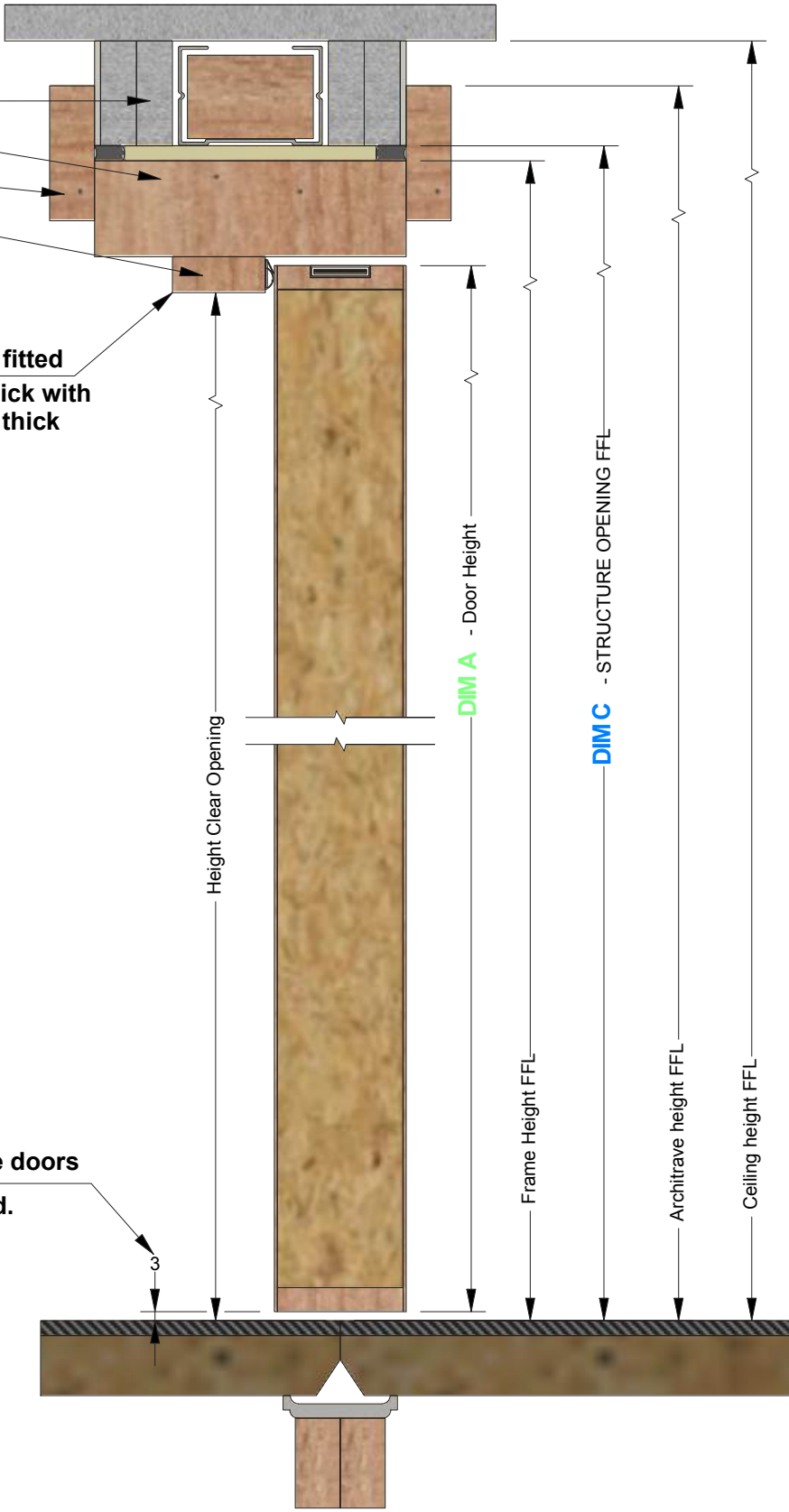

If a concealed closer is fitted
then door stop = 18mm thick with
door top lipping 20mm thick

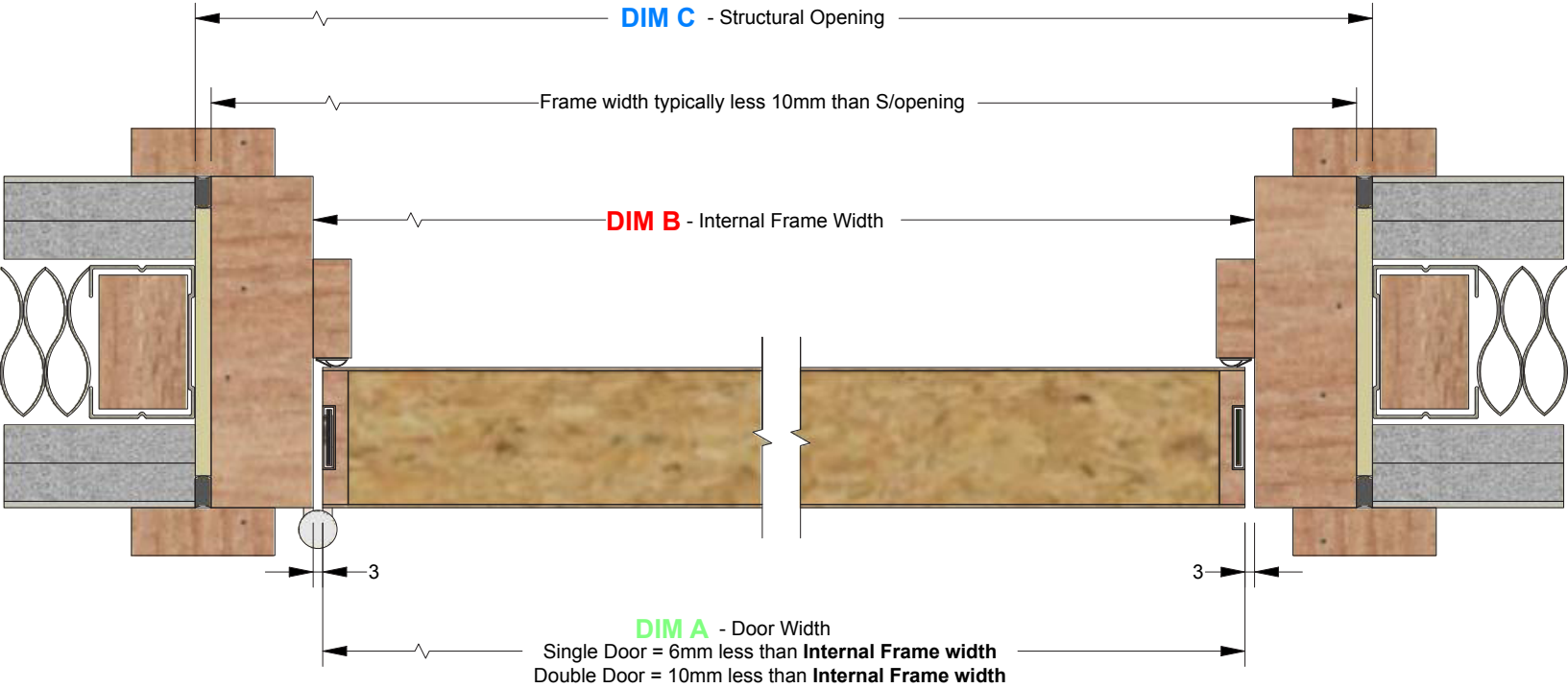

Max 3mm undercut for smoke doors
or 6mm if dropseal fitted.

LEFT HAND DOOR OPENING SHOWN

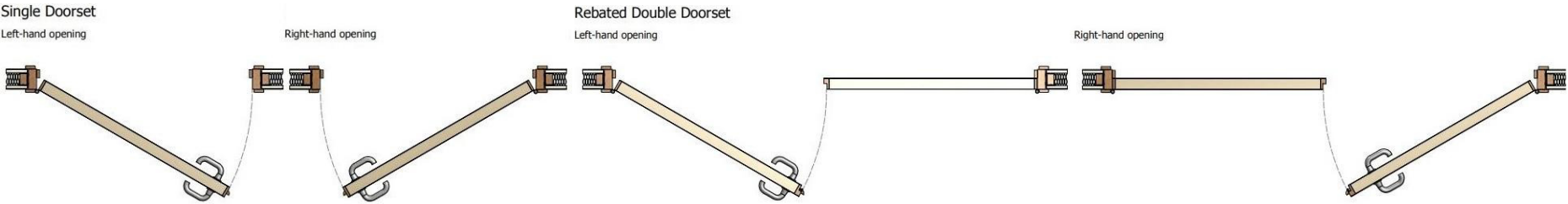

Title	Forza Typicals	Date	14/02/2019
Code	Site dimensions for door sets	Dwg No	FZDT001
Issue	1	Sheet	1 of 1



forza-doors.com
01403 711 126
info@forza-doors.com