

OTHER ELEVATION TYPES - Sidelight on both sides of the assembly, **M / N / O** - Fanlight above sidelight & assembly, **R / S / T** - 4-sided frame, **P / Q**

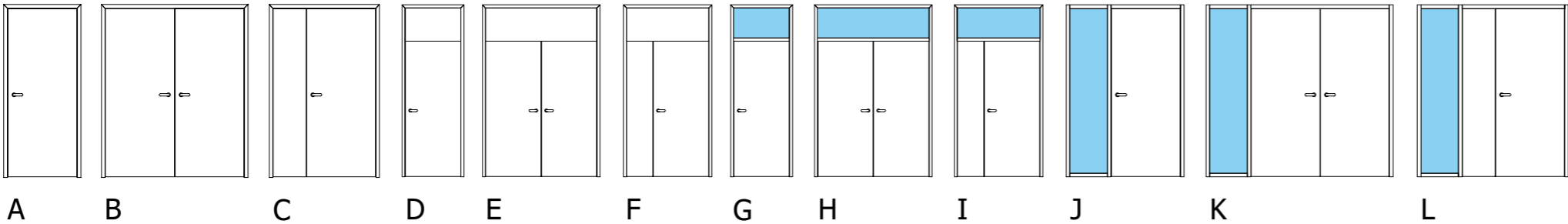

Permitted Elevations:

DOOR LEAF CORE: Average bulk density 630kgs / m3 Weight 54mm; Nom 34kgs / m2

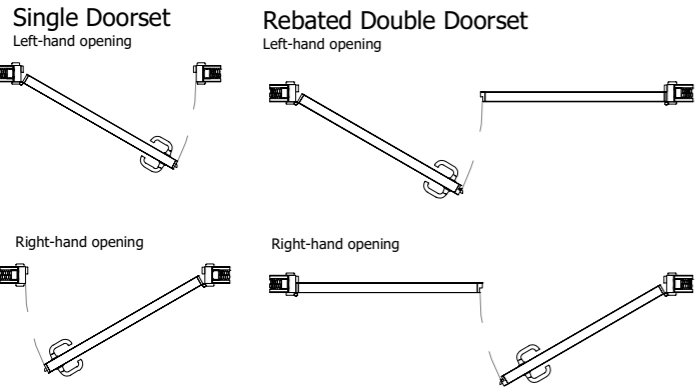

Door Handings:

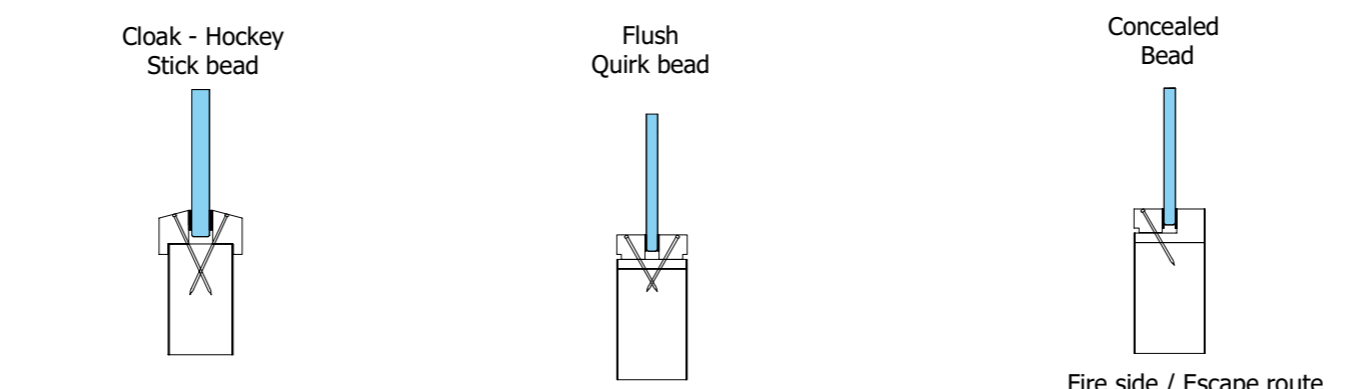

Bead Detail:

Glass: Clear fire glass

2-part Shadow-gap

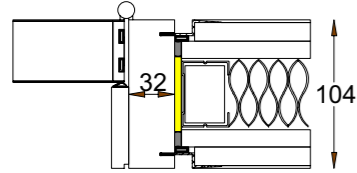

4-part

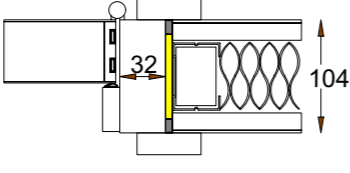

Double Action (Not available for cold smoke control)

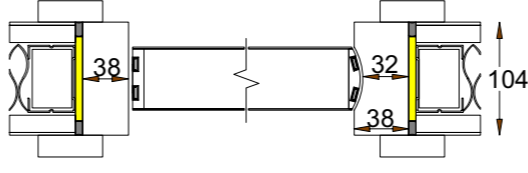

3-part

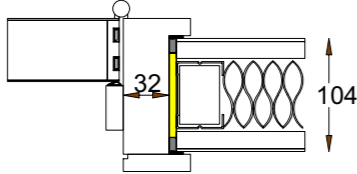

5-part Split

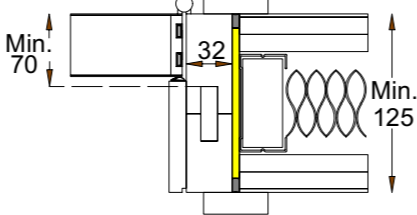

Typical mullion detail for elevations types J,K,L

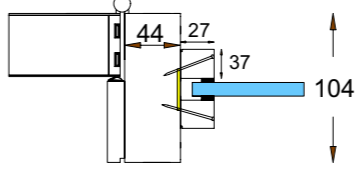

Typical Timber Doorframes: Hardwood minimum density 640kg/m3

Profile: integral stop / loose stop / rebated / shadow gap.

V3, V5, V8, V9, V10 comply with minimum zones of visibility Approved Document K 2013

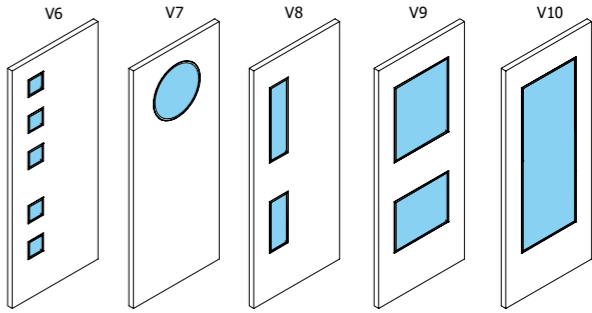
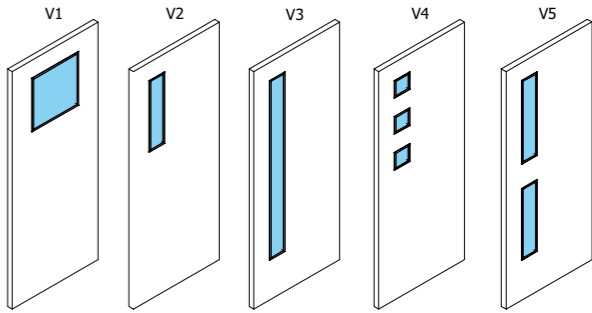

Standard Glazed Vision Panels:

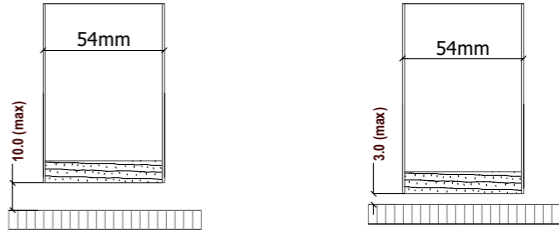

Fire Rated up to max 10mm threshold gap

Smoke Control up to max 3mm threshold gap

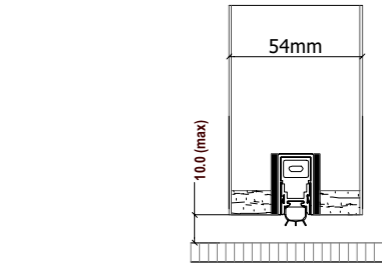

Fire Rated & Smoke Control up to max 10mm threshold gap with dropseal

Bottom Gap Detail:

If require a copy of the Forza FD60 certificate or installation guides, please download a PDF version of Forza's Website:

About us >>
Our certification

Performance & guides >>
Guidance on Frames installation FD60

Title: FD60 sales overview document
Drawing No: FZD5513
Issue: 2
Drawn by: Fabio Martins
Issue date: 21/09/2023

Sizes may vary depending on door core in use (FCS is the core used for reference) Factory max doors height up to 3000mm. Overpanels maximum high - Single set 1000mm / Double set 1000mm.	Maximum leaf size			
	MAX HT	ASSO. W	MAX W	ASSO. HT
Latch Single Action Single Door - LSASD (with over panel)	2499mm (2161mm)	1249mm (1080mm)	916mm (810mm)	3167mm (2702mm)
Latch Single Action Double Door - LSADD (with over panel)	2523mm (2059mm)	1143mm (988mm)	970mm (835mm)	2869mm (2366mm)
Unlatch Single Action Single Door - ULSASD (with over panel)	2451mm (2119mm)	1225mm (1059mm)	898mm (794mm)	3105mm (2649mm)
Unlatch Single Action Double Door - ULSADD (with over panel)	2498mm (2039mm)	1132mm (979mm)	961mm (827mm)	2841mm (2343mm)

Finishes

Forza primed coat (FPC) for painting by others.

Paint: RAL, BS 4800, Pantone colors. Standard sheen 20% gloss.

Laminate to conform to EN 438 & ISO 4586.

Wood veneer: Two coats high solid ultra violet (uv) cured lacquer, clear, 20% gloss / other.

Veneer standards available: Ash/ Cherry/Oak/St. Beech/Maple/American Black Walnut/others (all available in FSC)

Cut: Crown/Quarter/Rift/other.

Match: Book/Random/Slip/Quarter/other.

Grain direction: Vertical/Horizontal/Inlay/other.



60 Minutes Fire Rated (FD60) - STD 54mm Timber Fire Door in Timber or MDF Flush Frames

IMS Section:	Operational Controls
IMS Reference:	FD128
Domain:	Quality

Issue No:	02	Issue Date:	21/09/23	Issue Authorised By:	SHEQ Manager	Page 1 of 1
-----------	----	-------------	----------	----------------------	--------------	-------------



forza-doors.com
01403 711 126
info@forza-doors.com